

Technical drawings are subject to change without notice.
 All millimeter dimensions are exact and supersede inch conversions.

Copyright MWE NA Inc., all rights reserved. Reproduction or other use of these designs without written consent from MWE NA Inc. is prohibited.

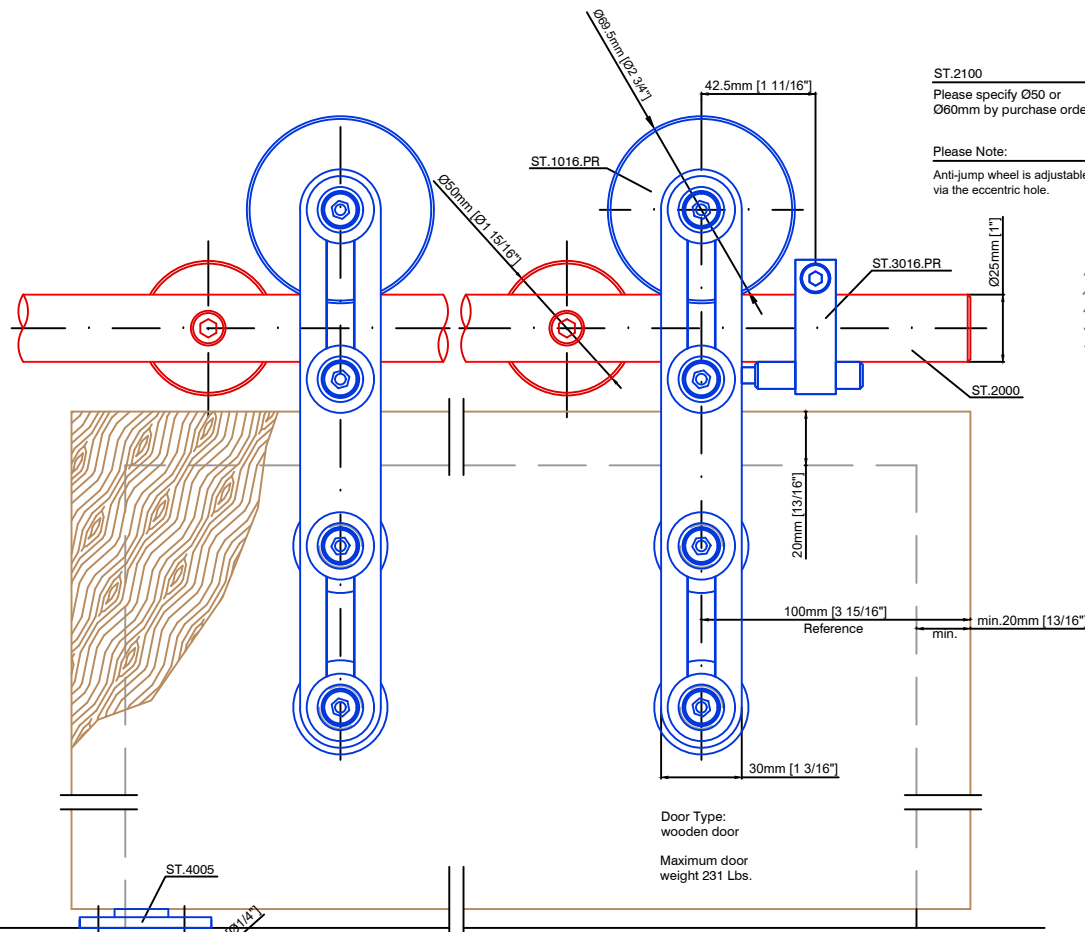

ST.2100
 Please specify Ø50 or Ø60mm by purchase order.

Please Note:
 Anti-jump wheel is adjustable via the eccentric hole.

Door Type:
 wooden door
 Maximum door weight 231 Lbs.

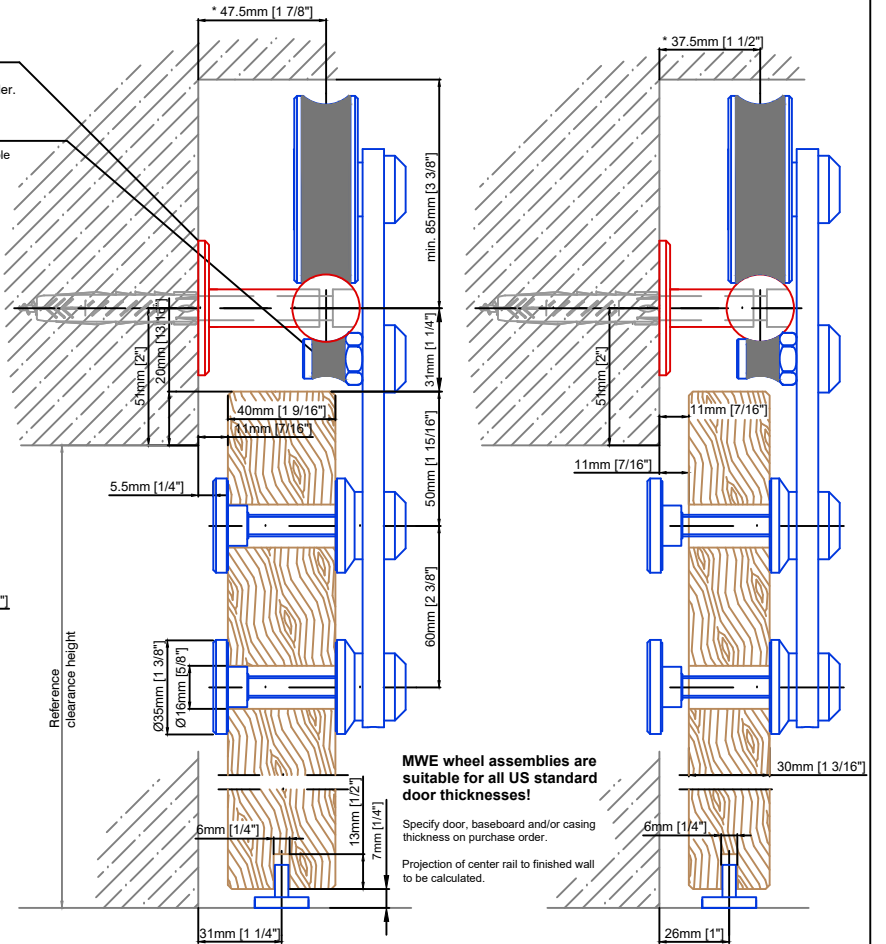

MWE wheel assemblies are suitable for all US standard door thicknesses!

Specify door, baseboard and/or casing thickness on purchase order.

Projection of center rail to finished wall to be calculated.

(*) ST.2100 Projection (center rail to finished wall)

- | | |
|------------------|-------------------|
| 17.5mm [11/16"] | 37.5mm [1 1/2"] |
| 22.5mm [7/8"] | 42.5mm [1 11/16"] |
| 27.5mm [1 1/16"] | 47.5mm [1 7/8"] |
| 32.5mm [1 1/4"] | 52.5mm [2 1/16"] |

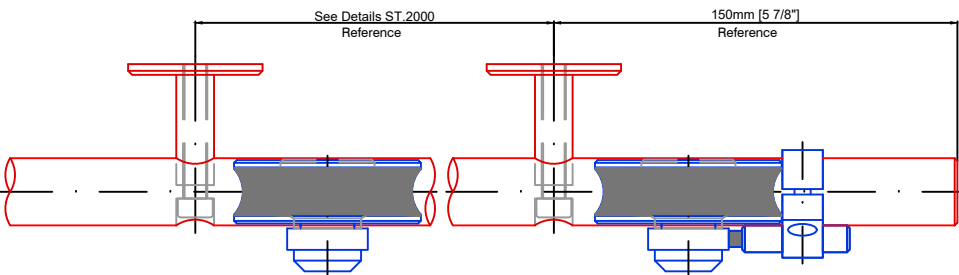

Protec ST.1016.PR

Date Prepared: July 2018

Prepared By: CDA | JRT



Email: info@mwe-na.com
www.mwe-na.com